

USER MANUAL

Reading carefully before using the machine



Thank you for choosing our products, you will have a pleasant experience.

1 Overview

Thank you very much for purchasing our diffuser. The product adopts the latest cold spray technology, no need to add water or heating, can be atomized into 1-3 nano particles, this atomization technology will not damage the molecular structure of essential oils, more conducive to human absorption. Automatic dumping Power off (45° power off) When the equipment is tipped over during operation, the power will be cut off immediately to prevent the essential oils from being absorbed into the body. When the device falls over during operation, it will immediately cut off the power supply, preventing the essential oil from leaking and causing damage to the device. Compared with traditional aromatherapy machines, it is safer and less likely to cause bacterial growth due to frequent water changes.

As it is compatible with the majority of essential oil bottles available, it gives you the freedom to choose from a wide range of fragrances that soothe you, relax you, or refresh you in a variety of situations. Using it with sanitizing essential oils can improve unpleasant odors and help purify the air around it.

2 Cautions



- **DO NOT** invert or tilt the device once the oil bottle is installed.
- **DO NOT** use it with camphor tree oil.
- **DO NOT** attempt to disassemble the device.
- For more quiet use, ensure the unit is **3 feet away**.
- Keep the device away from children and pets.
- The more concentrated the oil, the less diffusing ability.
- If you do not plan to use this device for an extended period of time, please store the device and the nozzle separately.
- Working Temperature: **0°C -45°C**

Inverted

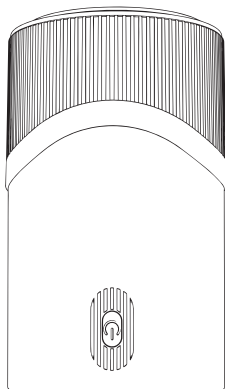

Tilted

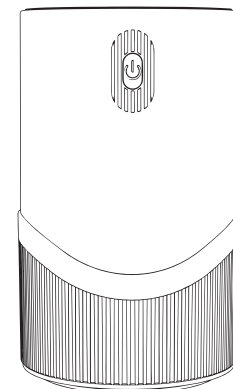
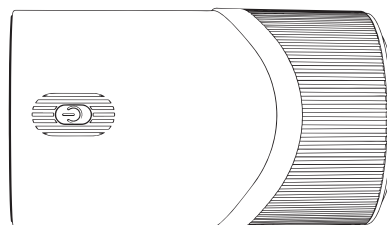

3 Touch Button and Info Display

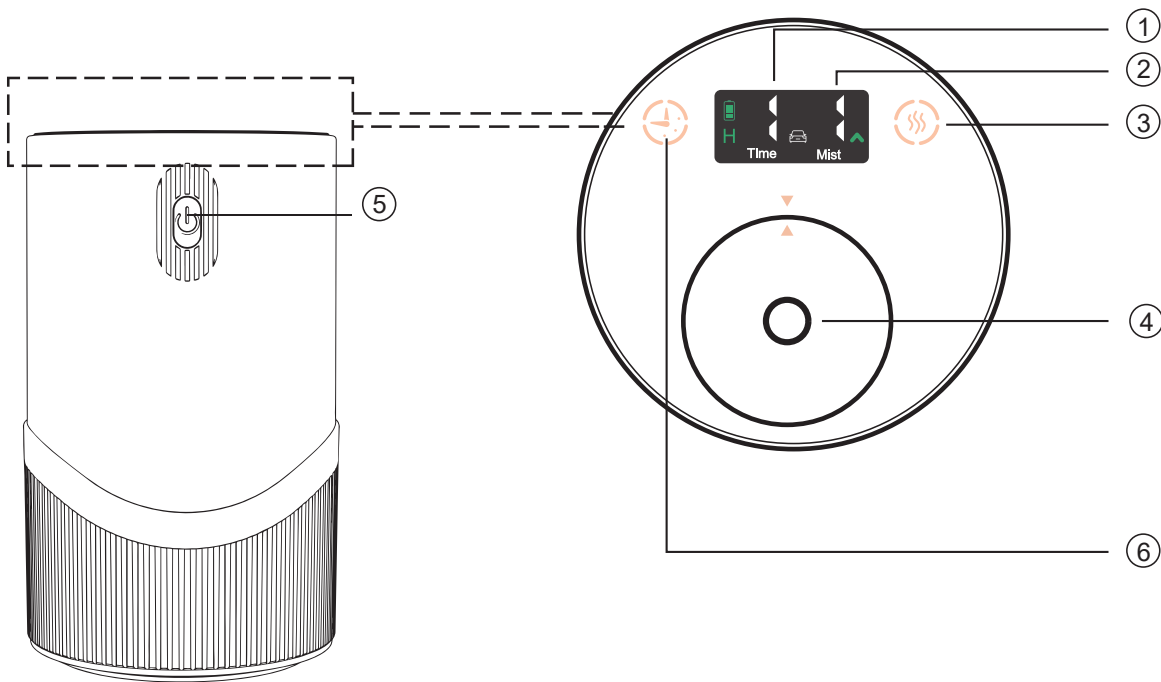

1 Timer

2 Atomization modes

3 Short press : Vehicle mode

Press and hold for 1.3 seconds to switch between vehicle modes

4 Spray nozzles

5 Power switch

Two short presses:
turn on/off ambient light

6 Short press : Home mode

Press and hold for 1.3 seconds to switch home mode

Vehicle mode



Level 1

Atomization 5S
dormancy 55S.



Level 2

Atomization 10S
dormancy 50S.



Level 3

Atomization 15S
dormancy 45S.



Level 4

Continuous spray



1 hour

After working for 1 hour, the product will automatically turn off.



2 hours

After working for 2 hours, the product will automatically turn off.



3 hours

After working for 3 hours, the product will automatically turn off.

Home mode



Level 1

Atomization 30S
dormancy 150S.



Levels 2

Atomization 60S
dormancy 120S.



Levels 3

Atomization 120S
dormancy 60S.



Levels 4

Continuous spray



1 hour

After working for 1 hour, the product will automatically turn off.



2 hours

After working for 2 hours, the product will automatically turn off.



4 hours

After working for 4 hours, the product will automatically turn off.



6 hours

After working for 6 hours, the product will automatically turn off.

Cautions



Digital Display Screen

Follow the atomization modes to turn on/off the screen.

Screen on when spraying, Sleep screen off.

When the car mode is intermittent, the "🚗" light is always on,

When the home mode is intermittent, the "🏠" light is always on.



Battery Charging

The green indicator will show the charging status until the battery is fully charged.

4 What's in the Box

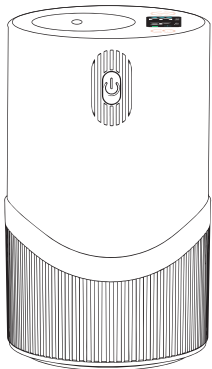

Diffuser

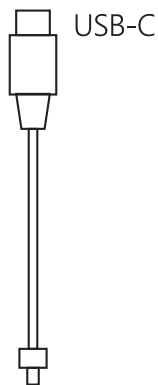

Charging Cable

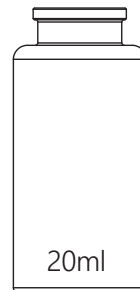

Standard Oil Bottle

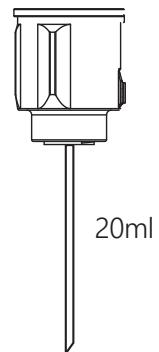

Nozzle

5 Bottle Installation

- The device is compatible with 5/10/15/20ml bottles.

①

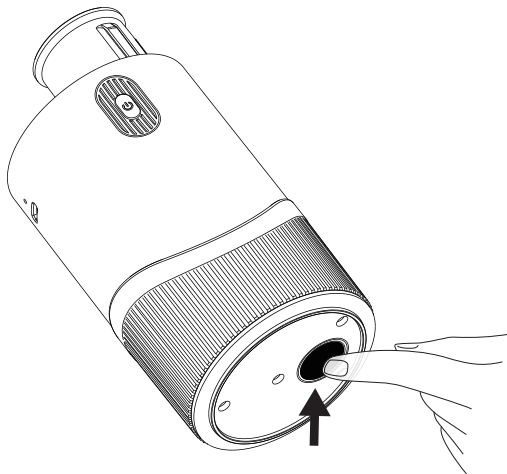

Withdrawal method:

Press the bottom button firmly with your finger to eject the nozzle.

②

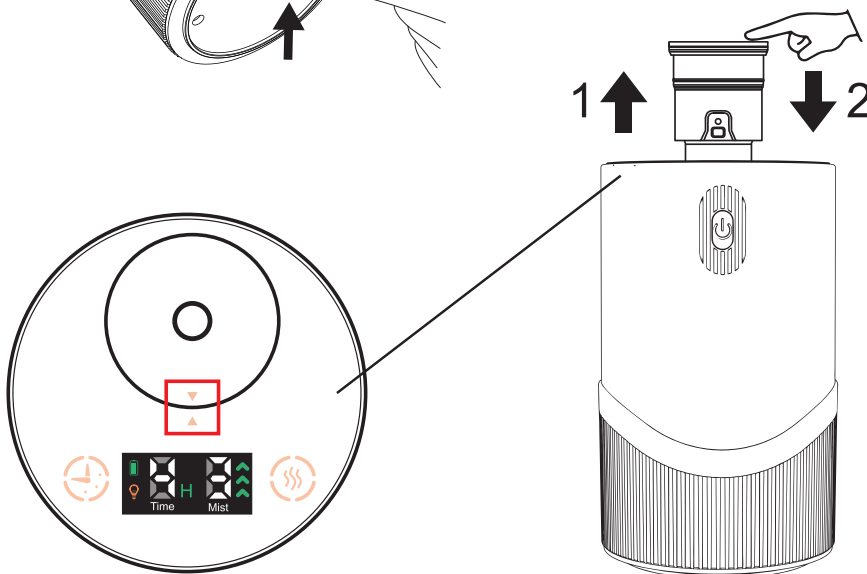

Installation:

Twist the bottle onto the nozzle and press the nozzle down to complete the installation. To install correctly, please look for the "▲▼" sign before pushing the nozzle.

6 Charging

 Normal charging time: 3-5 hours. If the charging current is below 1A, it will take longer to fully charge the device.

- You may charge from a 5V adapter, PC/MAC USB port, or USB interface within your vehicle. Please ensure that use safety-certified charging accessories.



PC/MAC USB port

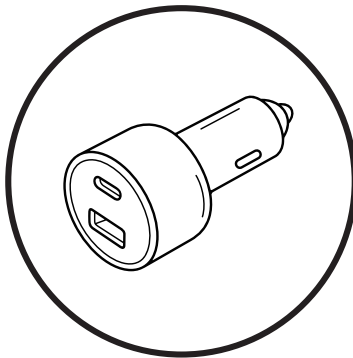

Car USB port

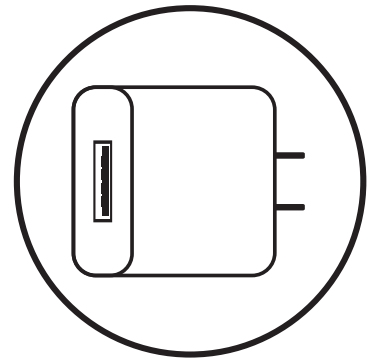

Adapter

- The battery indicator flashes green while charging and stays green when charging is complete.
- As charging cycles increase, battery life will decrease.

7 Specifications

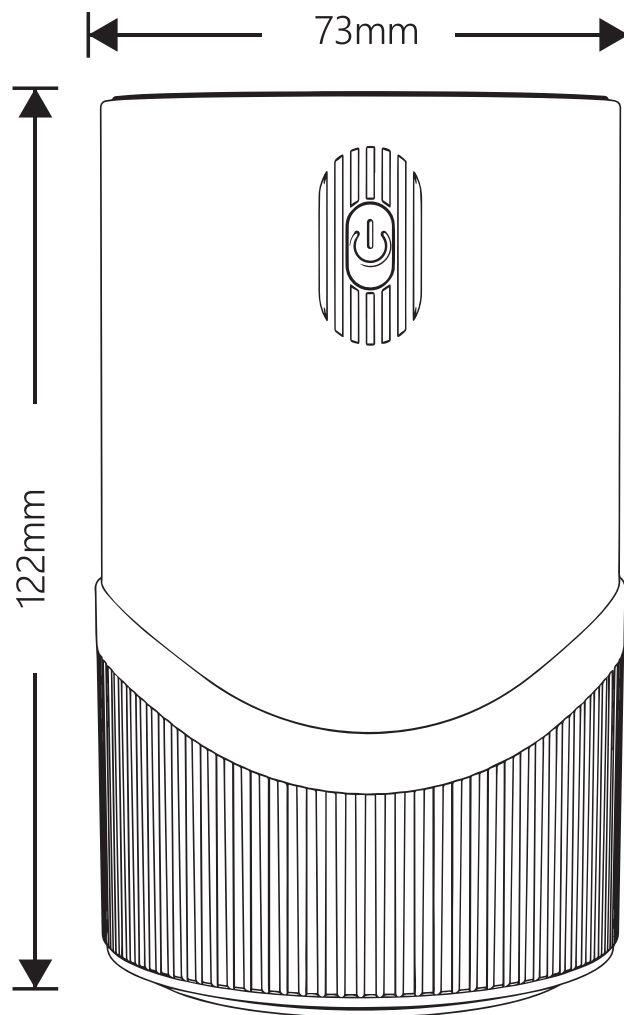

Product type: PR-66B

Oil Capacity: 5-20ml

Input: DC-5V/1A

Rated Power: 5W

Material: PP+PC+Aluminium alloy

Size: 73*122mm

Battery Capacity: 2000mAh

Net Weight: 410g

8

FAQ

Q1: How to select the right essential oil?

Use 100% pure essential oils. Resin and thick oil are not recommended. Camphor tree and eaglewood oils are prohibited.

Q2: When I change to a new oil, there is mixed smell coming from my previous oil. How do I clean the nozzle and the bottle?

Regular cleaning: fill the empty bottle with 5ml of 99% ethyl/ethanol alcohol, then run the device until it runs out.
Deep cleaning: fill up the 20ml bottle with 99% ethyl/ethanol alcohol, then install the bottle into the device and soak for 1 day. Remove the alcohol and then refill with another 5ml of ethyl/ethanol alcohol. Run the device until it runs out.

Q3: I feel like it stops running sometimes, what has happened?

Please refer to section 4 for 'mist level explained'. The device is able to automatically optimize atomizing/pausing according to mist level.

Q4: How long does it take to fully charge the device?

Normally 3-5 hours.